

0750.007 - GRN 250/2/G40H A1DT5 NGTAB51040N00EX

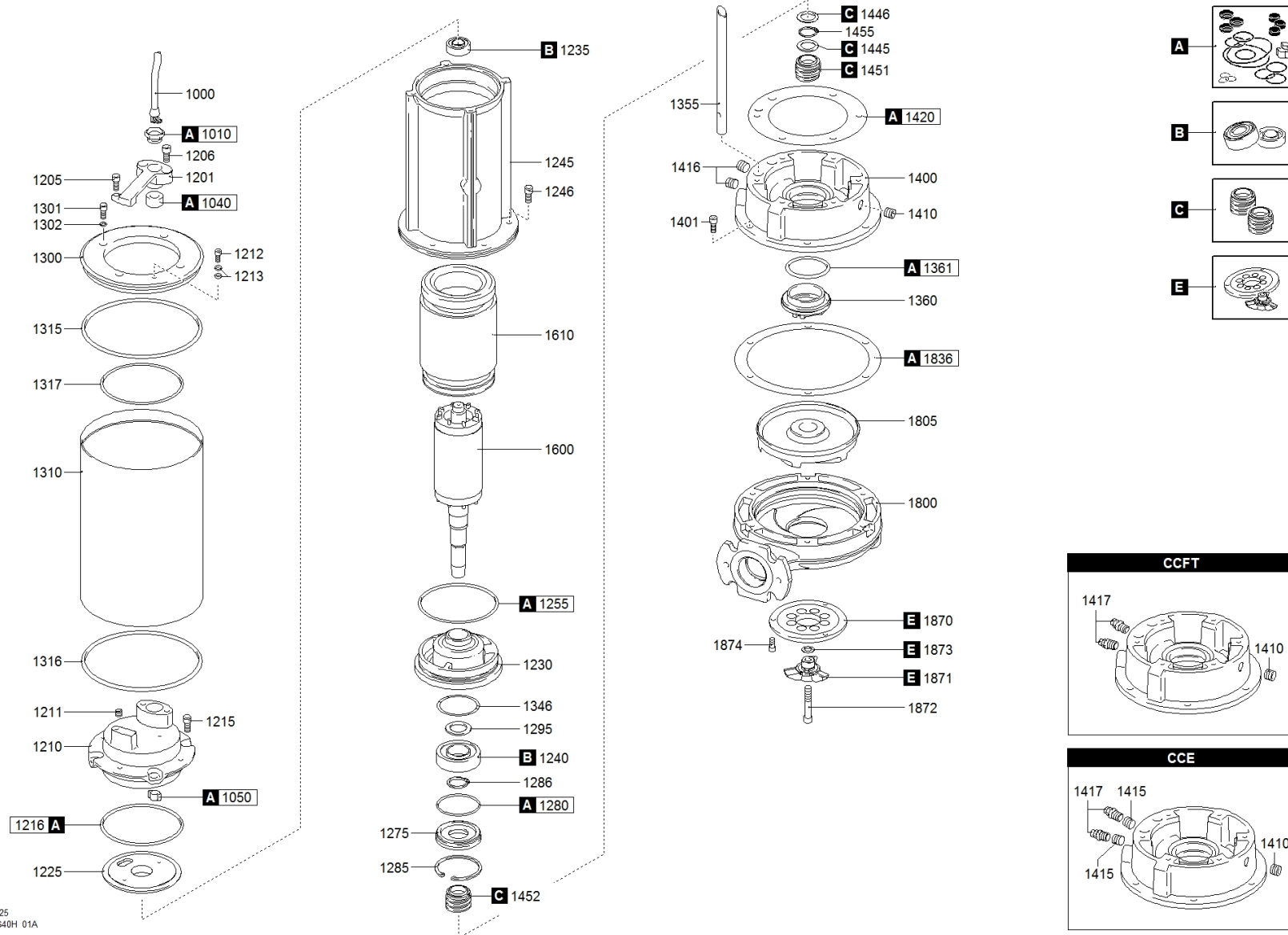

N N125
GR G40H 01A



water solutions



0750.007 - GRN 250/2/G40H A1DT5 NGTAB51040N00EX

		Code		Description		Q.ty	Price (€)
A		601011001		GASKETS KIT	711077	1	
C		602010091		MECHANICAL SEALS KIT	802063	1	
E		603011201		CUTTING SYSTEM KIT		1	
B		604011001		BEARINGS KIT		1	
1000		25020340151000001		POWER CABLE	802306	1	
1010		235467216820		RING NUT [POWER CABLE]	711016 OR 802074	1	
1040		235672724120		RUBBER GASKET [POWER CABLE]	802073	1	
1050		2732001400000		COLLAR CLAMP [POWER CABLE]	802081	1	
1201		235322017950		CABLE GLAND HANDLE	802072	1	
1205		270830810203200000		SCREW [HANDLE >> COVER]	802093 OR 802095	1	
1206		270830810203200000		SCREW [CABLE GLAND HANDLE >> COVER]	802093 OR 802095	2	
1210		232115023314		COVER	802071	1	
1211		270139510104000000		CAP [TIGHTNESS TEST]	802099	1	
1212		270830610123200000		SCREW [GROUND CABLE]	802092	1	
1213		270530203162000000		WASHER [GROUND CABLE]	802097	3	
1215		270830810203200000		SCREW [COVER >> MOTOR CASE]	802093 OR 802095	4	
1216		271770126035100000		GASKET [COVER >> MOTOR CASE]	802105	1	
1225		230615017920		UPPER BEARING HOLDER	802069	1	
1230		230515023313		LOWER BEARING HOLDER	802068	1	
1235		2729062030200000		UPPER BEARING	711360 OR 802083	1	
1240		2729063060200000		LOWER BEARING	710970 OR 802082	1	
1245		231015023366		MOTOR CASE	802070	1	
1246		270830810253200000		SCREW [MOTOR CASE >> OIL CHAMBER]	802094	6	
1255		271770117035100000		GASKET [MOTOR CASE >> LOWER BEARING HOLDER]	802104	1	
1275		2391075032023312		LOWER BEARING FLANGE	802077	1	
1280		271770066026100000		GASKET [LOWER BEARING FLANGE]	802107	1	
1285		2703207502000000		SEEGER [LOWER BEARING FLANGE >> MECHANICAL SEAL]		1	
1286		2703303001000000		SEEGER [LOWER BEARING >> LOWER BEARING FLANGE]	802102	1	
1295		270220300422500000		UPPER DISTANCE RING [LOWER BEARING]	802098	1	
1346		27542071000000		WAVE SPRING	802108	1	
1360		2307103023311		BUSH [OIL CHAMBER]	802076	1	
1361		271770065035100000		GASKET - BUSH [OIL CHAMBER]	802106	1	
1400		238611602523300		OIL CHAMBER	802075	1	
1401		270830810203200000		SCREW [OIL CHAMBER >> PUMP BODY]	802093 OR 802095	2	
1401		270830810203200000		SCREW [OIL CHAMBER >> PUMP BODY]	802093 OR 802095	4	
1401		270830810253200000		SCREW [OIL CHAMBER >> PUMP BODY]	802094	2	
1410		270139530104000000		CAP [OIL CHAMBER]	802100	1	
1420		2750913023350		GASKET [LOWER BEARING HOLDER >> OIL CHAMBER]	710951	1	

1445	270531920402000000	WASHER [1st MECHANICAL SEAL]	711049 OR 804845	1
1446	270531920402000000	WASHER [2nd MECHANICAL SEAL]	711049 OR 804845	1
1451	230000212250000000	1st MECHANICAL SEAL	711384	1
1452	230000212250000000	2nd MECHANICAL SEAL	711384	1
1455	270330250100000	SEEGER [1st MECHANICAL SEAL >> 2nd MECHANICAL SEAL]	802101	1
1600	230232612223361	SHAFT WITH ROTOR		1
1610	231101223001000000	WOUND STATOR		1
1650	2790360424886	DATAPLATE	802080	1
1655	273130000000	RIVET [DATAPLATE]	802085	2
1800	21251516015123486	PUMP BODY	802300	1
1805	21411501080523664	IMPELLER	806167	1
1836	2750916023613	GASKET [OIL CHAMBER >> PUMP PLATE]	710955 OR 802282	2
1870	211730401250	CUTTING DISK	711415	1
1871	211630824028	CHOPPER KNIFE	710901	1
1872	270830810503200000	LOCKING CHOPPER KNIFE		1
1873	270620120180200000	WASHER [CHOPPER KNIFE]	711051	3
1874	270830610143200000	SCREW [CUTTING DISK >> PUMP BODY]	806113	3